

**INDIAN INSTITUTE OF TROPICAL METEOROLOGY (IITM)
PASHAN, PUNE-411 008**

Tender No. IITM/CE/RENO/PM&A/15-16/13

e-TENDER NOTICE

Director, Indian Institute of Tropical Meteorology, Dr. Homi Bhabha Road, Pashan, Pune-411 008, (India). Invites sealed separate tenders for following work (Part-I – Technical Bid, Part-II – Commercial Bid) in separate sealed covers from Contractors registered in the approved list of contractors of PWD/MES/ CPWD/ Railways/P&T/Industrial Experienced contractors and any other government departments in appropriate class for following work:

Name of work: Renovation of Chemistry lab in room no. 305 and making cubical in room no. 303 & 307 at second floor PM & A division at IITM, Pashan, Pune.

Tender documents can be down loaded from the institute website <http://www.tropmet.res.in> or e – procurement web site <http://eprocure.gov.in> and can also be obtained from the civil wing of the institute.

The tender document fee: Rs 500-/, (Rs Five hundred only) [Non Refundable] by demand draft drawn in the favour of Director, IITM, Pune.

Date of issue of tender documents : 01/03/2016
Pre - Bid Meeting : 08/03/2016 (1100rs)
Venue of Pre-Bid meeting : Indian Institute of Tropical Meteorology,
Dr. Homi Bhabha Road, Pashan, Pune 411 008

Last date of receipt of Tender at IITM, Pune : 23/03/2016 (12 30hrs)
Opening of Tenders (Technical Bids only) : 23/03/2016 (15 00hrs)

The Institute reserves the right to reject any or all tenders without assigning any reason thereof.

Civil Engineer
For Director
IITM, PUNE



TENDER FOR

RENOVATION OF CHEMISTRY LAB IN ROOM NO. 305 AND MAKING CUBICAL IN ROOM NO. 303 & 307 AT SECOND FLOOR PM & A DIVISION AT IITM, PASHAN, PUNE.

VOLUME-I

(TECHNICAL BID)



INDIAN INSTITUTE OF TROPICAL METEOROLOGY,
DR.HOMI BHABA ROAD, PASHAN, PUNE-411008

TENDER FOR

RENOVATION OF CHEMISTRY LAB IN ROOM NO. 305 AND MAKING CUBICAL IN ROOM NO. 303 & 307AT SECOND FLOOR PM & A DIVISION AT IITM, PASHAN, PUNE.

Tender No. : IITM/CE/RENO/PM&A/15-16/13
Name of work : **Renovation of Chemistry lab in room no. 305 and making cubical in room no. 303 & 307at second floor PM & A division at IITM, Pashan, Pune.**
Tender document fee: Rs 500/-, (Rs Five hundred only) [Non Refundable] by Demand draft drawn in the favour of Director, IITM Pune-411008.

Date of issue of tender documents from: 01/03/2016

Pre - Bid Meeting : 08/03/2016 at 11 00 hrs.

Venue of Pre-Bid meeting : Indian Institute of Tropical, Meteorology,
Dr. Homi Bhaba Road, Pashan,
Pune-411008

Last date of receipt of Tender at IITM, Pune: 23/03/2016 at 12 30 hrs.

Opening of Tenders (Technical Bids only) :23/03/2016 at 15 00 hrs.

Estimated Cost : **Rs. 15.33 Lakhs**

COMPLETION PERIOD : **60 days** from the date of handing over of site to contractor by the Institute to commence the work.

Ernest Money Deposit (EMD): **Rs.31,000/- (Rs. Thirty one thousand only)** by demand draft (DD) or Bank Guarantee (BG) from Nationalize/Schedule Bank in favor of The Director IITM, Pashan, Pune-411008.



**NOTICE INVITING TENDER FOR
RENOVATION OF CHEMISTRY LAB IN ROOM NO. 305 AND MAKING CUBICAL IN
ROOM NO. 303 & 307 AT SECOND FLOOR PM & A DIVISION AT IITM, PASHAN, PUNE.**

**FOR
INDIAN INSTITUTE OF TROPICAL METEOROLOGY,
DR.HOMI BHABA ROAD, PASHAN, PUNE-411008**

TWO COVER SYSTEM

Tender Notice No. IITM/CE/RENO/PM&A/15-16/13

Director, Indian Institute of Tropical Meteorology, Pune, invites bid for the said work under the **Two Cover System** from the contractors who meet the following criteria.

1. Contractor shall produce definite proof of valid contractor license/enlistment certificate with the CPWD/State PWD/MES Railways issued by the respective enlistment authority of the concerned department for the amount not less than estimated amount of the work.
2. For works of similar nature
 - i) Average annual financial turnover for similar works during the last 3 years ending 31st March 2015 of the previous should be at least 30% of the estimated cost.
 - ii) Experience of having successfully completed similar works during last 7 years ending last day of month previous to the one in which applications are invited should be either of the following:-

The BIDDER should have three similar completed works costing not less than the amount equal to 40% of the estimated cost.

Or

Two similar completed works costing not less than the amount equal to 50% of the estimated cost.

Or

One similar completed work costing not less than the amount equal to 80% of the estimated cost.

4. A sum of Rs. 500/- (Non - Refundable) for the cost of tender documents DD drawn in favour of Director, IITM.
5. This tender is not transferable.
6. The rates for BOQ items total cost of work should be mentioned clearly in the Commercial Offer (Part-II) as per commercial bid format only.
7. **Tenders received through Fax / E-mail / Telegraphic / Telex will not be considered.**
8. Tenders addressed to the Director, Indian Institute of Tropical Meteorology, Pune 411008 are to be submitted under two bids system. Super-scribed with Tender Notice No., name of work, due date and time and it should be submitted before due date and time.



9. The tenders must be clearly written or typed without any cancellations / corrections or overwriting.
 - a) Tenders, which are submitted without following the Two-Bid Offer System, will summarily be rejected.
 - b) Unsigned Tenders will also be rejected.
 - c) Part and incomplete tenders are liable to be rejected.
10. The tenders will be received in the Institute till 23/03/2016 up to 12 30 hrs and shall be opened on 23/03/2016 at 15:00 hrs (Technical Bids only) in presence of the tenderers or their authorized person who wish to be present.
11. IITM will not be responsible:
 - a) For delayed / late quotations submitted / sent by Post / Courier etc.
 - b) For submission / delivery of quotations at wrong places other than the Office of Director, IITM, Pune.
12. The tender / quotation / offer submitted by the firm should be valid for a minimum period of One hundred twenty days (120) days from the date of opening the tender.
13. If required technical evaluation committee of IITM will visit to bidder's completed site and submit the report to IITM Pune. Based on IITM Committee report bidders will be qualified/disqualified.
14. The commercial bids of only technically qualified bidders will be opened by the Institute.
15. Delivery Period - As the time is the essence of the contract, period of completion of work should be strictly adhered to.
16. The Tenderer is required to furnish the documentary proof of Permanent Account Number (PAN) and Service Tax no. if any allotted by the Income Tax Department. If registered with the National Small Industries Corporation, the registration number, purpose of registration and the validity period of registration, Firms registration with competent authority, company profile etc. should also be provided in Technical Bid.
17. A copy of latest Income Tax Clearance Certificate from Income Tax Department (INDIA) for in Technical Bid.
18. The bidders are requested to submit their bank details required for RTGS Payment.
- 19) **PAYMENT:**
 - a) No advance can be paid.
 - b) **Running** payment total bill limit will two. RA bills not less than 5.00 lakhs each.
 - c) No price escalation will be granted.
- 20) **Performance security** 5% of order value in the form of DD/BG drawn on Nationalized Bank/Scheduled bank in favor of Director IITM, Pune payable at Pune.
- 21) **Retention money:** 5% security deposit will be recovered & retained from each running bill which will be refunded after defect liability period of 12 months from the date of handing over the clear site
- 22) **Non tendered items:** The Rate for non-tendered items will be arrived as per following: material cost at site + labour cost + taxes + 10% overhead & profit. Non tendered items will be executed only with prior approval of Institute's authority.



- 23) **DEVIATION:** Additional work/any deviation beyond work order quantities requires prior approval of the IITM authorities before execution of such work. The permissible overall deviation from the work order value is 10% and such deviation should not be executed at site without prior approval of Institute's authority.
- 24) **DEFECT LIABILITY PERIOD:** Defect liability period of the work will be 12 months from the date of actual completion of work and clear handing over of the site by the contractor to the Institute.
- 25) The successful bidder will be responsible for all activities on the site as per safety norms and building code
- 26) Government/labour Act- The successful bidder will follow all the government labour acts which are in force at present and introduce from time to time.
- 27) The prices quoted should be firm and irrevocable and not subject to any change whatsoever, even due to increase in cost of raw material components and fluctuation in the foreign exchange rates and excise duty.
- 28) IITM will not provide any accommodation / transportation for the Engineers/Representatives.
- 29) No sub-contracting will be allowed for installation or maintaining system/ equipment/ instrument during or after warranty period.
- 30) Discount if any offered should be mentioned clearly in the commercial bid only.
- 31) The Earnest Money Deposit of **Rs.31,000/- (Rs. Thirty one thousand only)** must be paid / sent along with your technical bid in the form of a Demand Draft, or Bank Guarantee drawn on Nationalized Bank drawn in favor of **The Director, Indian Institute of Tropical Meteorology, Pune payable at Pune**, otherwise your technical & financial bids will not be considered at all.
- 32) The Earnest Money of the unsuccessful bidder whose technical bid has not been found suitable will be returned within 30 days after award of work to successful bidder.
- 33) Tenders not accompanied with Demand Draft / Bank Guarantee towards "Earnest Money Deposit" and tender fee will summarily be rejected.
- 34) **PENALTY:** If the Contractor fails to carry out the work as per specifications mentioned in the BOQ within the due date, the contractor is liable to pay liquidated damages of one percent, per every week delay subject to a maximum of 10% of work order value and such money will be deducted from any money due or which may become due to the supplier. Period of completion will be counted from the date of handing over the site to contractor for execution of work.
- 35) Decision of Director, IITM in regard of interpretation of the terms and conditions shall be final and binding on the vendor.

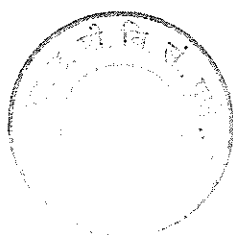

36) Corrupt or Fraudulent Practices.

A) IITM requires that the bidders/contractors under this tender observe the highest standards of ethics during the procurement and execution of such contracts. In pursuance of this policy, IITM:

i) Defines for the purposes of this provision, the terms set forth as follows:

a) "Corrupt practice" means the offering, giving, receiving or soliciting of anything of value to influence the action of the public official in the procurement process or in contract execution; and

b) "Fraudulent practice" means a misrepresentation of facts in order to influence a procurement process or a execution of a contract to the detriment of IITM, and includes collusive practice among bidders (prior to or after bid submission) designed to establish bid prices at artificial non-competitive levels and to deprive IITM of the benefits of the free and open competition;

ii) Will reject a proposal for award if it determines that the Bidder recommended for award has engaged in corrupt or fraudulent practices in competing for the contract in question;

B) IITM will declare a firm ineligible, either indefinitely or for a stated period of time, to be awarded a contract if it at any time determines that the firm has engaged in corrupt and fraudulent practices in competing for, or in executing, a contract.

37) Conditional Offers will not be considered.

38) All disputes are subject to exclusive jurisdiction of Competent Court and Forum in Pune, India only.

39) The Director, Indian Institute of Tropical Meteorology, Pune 411 008, India reserves the right to accept any tender in full or in part or to reject the lowest or any or all tenders without assigning any reason.

40) EMD forfeiting:

a) If bidder withdraws the bid after opening during the period of bid validity.

b) In case of a successful bidder, if bidder fails within the specified time limit to sign the agreement and furnish the performance security.

41) The Electricity for the execution of the work will be provided on chargeable basis. Sub meter and required cable to be arranged by successful bidder.

42) The Director, Indian Institute of Tropical Meteorology, Pune will be the final authority to decide the appropriate action and it will be binding on the Vendor.

*Only one set of document will be issued. Contractors have to take additional copies.



43) **BID SUBMISSION**

Technical Bid-I along with forwarding application on their company letter head, complete tender documents, blank BOQ, related documents duly signed and stamped on each page in sealed ENVELOPE superscribe with TECHNICAL BID and Part - II Commercial Bid duly filled and signed in separate sealed ENVELOPE superscribed with COMMERCIAL BID and Both the sealed bids should be sent in another sealed envelope superscripted with Tender notice no., due date and time addressed to the Director, Indian Institute of Tropical Meteorology, Dr. Homi Bhabha Road, IITM, Pashan, Pune - 411 008, INDIA so as to reach on or before 23/03/2016 (12 30hrs). **The technical bids will be opened on the same day at 15 00 hrs.**

[Note: Late received bids will not be considered for tender opening and further evaluation]

- 44) The Director, Indian Institute of Tropical Meteorology, reserves the right to accept/reject Anyone / all the tenders without assigning any reason thereof.

CIVIL ENGINEER
FOR DIRECTOR,
INDIAN INSTITUTE OF TROPICAL
METEOROLOGY, DR. HOMI BHABHA ROAD,
NCL POST, PASHAN
PUNE - 411008.INDIA



-AGREEMENT-

This agreement, made the day of ,2016 between Indian Institute of Tropical Meteorology, Homi Bhabha road, Pashan, Pune (hereinafter called _ the Employer) II of the one part and M/s. ----- II of the part

Whereas the Employer is desirous that the Contractor execute -----at Indian Institute of Tropical Meteorology, Pashan, Pune (hereinafter called _ the Works II) and the Employer has accepted the Bid by the Contractor for the execution

And completion of such works and the remedying of any defects therein, at a Contract Rs. -----

THIS AGREEMENT WIRNESSETH as follows:

1. In this Agreement, words and expression shall have the same meaning as are respectively assigned to them in the Conditions of Contract hereinafter referred to, and they shall be deemed to form and be read and construed as part of this Agreement.
2. In consideration of the payments to be made by the Employer to the Contractor as hereinafter mentioned, the Contractor hereby covenants with the Employer to execute and complete the works and remedy any defects therein conformity in all aspects with the provisions of the Contract.
3. The Employer hereby covenants to pay the Contractor in consideration of the execution and completion of the works and the remedying the defects wherein the contract Price or such other sum as may become payable under the provisions of the Contractor at the times and in the manner prescribed by the contract.
4. The contractor shall not be responsible for any delays due to changes in drawings, specifications, scope of work or any other reasons attributable to the client, his representatives and other contractors. The contractor shall also not be responsible for any delays occurring due to force majeure situations during the execution of the work.
5. **PENALTY CLAUSE:** If the Contractor fails to carry out the work as per specifications mentioned in the BOQ within the due date, the contractor is liable to pay liquidated damages of one percent, per every week delay subject to a maximum of 10% of work order value and such money will be deducted from any money due or which may become due to the supplier. Completion period will be calculated from the date of handing the site to contractor for execution of work.



6. Other terms and conditions will be applicable as per Tender document and issued LOI dated on-

7. The Director, Indian Institute of Tropical Meteorology, Pune will be the final authority to decide the appropriate action and it will be binding on the Vendor. Decision of Director, IITM in regard of interpretation of the terms and conditions shall be final and binding on the vendor.

In witness whereof the parties thereto have caused this Agreement to be executed the day and Year first before written.

Signed and delivered for and on behalf of M/s. ----- Signed and delivered for and on behalf of Indian Institute of tropical Meteorology, Pashan

1) Signature
Name:

Address:

1) Signature
Name:

2) Signature
Name:

2) Signature
Name:



Sr. No	Description	Qty.	Unit	Basic Rate Rs.	Taxes		Total rate (Basic + taxes) Rs.	Amount
					Service tax %	Vat %		
A) Civil work								
1	Dismantling of existing mosaic wall tiles (skirting) including back coat plaster racking of brick work joints etc to make it clean and ready for new back coat plaster as required for new tiling work and removing of all debris out of IITM premises all as directed by Engineer-in-charge.	3	Sq. m.					
2	Dismantling of old wash basins and shifting to store including fitting fixtures etc. & disposing off the debris material beyond PMC limit all as directed by Engineer In charge.	2	No.					
3	Providing and fixing storage counter 2' 6" depth x 2' 6" height with 18mm thick ply board for top, bottom sides and front sliding/ openable shutter and 12mm thick ply board with both side laminate for back side, necessary vertical support at 3' c/c including edge laminate / lipping, all necessary support fittings fixtures such as runner / guide rail, handles, hinges, key locks etc. complete in all respect all as Directed by engineer-In- charge.	30	R.ft.					
4	Providing and fixing over head storage depth 2'6" x width 1'3" with 18mm thick ply board for top, bottom sides and front openable shutters and back side 12mm thick plyboard with both side laminate , necessary vertical support at 3' c/c including edge laminate / lipping , all necessary support fittings fixtures such as handles, hinges, magnet , key locks etc. complete in all respect all as Directed by engineer-In- charge.	30	R.ft.					
5	Providing and fixing working platform width 2'6"x height 2'6" with below storage in 18mm thick ply on top and 18mm thick granite top and for sides, bottom & front with 18mm thick ply both side laminate , edge laminate/ lipping including necessary support, fittings, fixtures such as handles, hinges, magnet , key locks etc. complete in all respect all as Directed by engineer-In-charge.	30	R.ft.					
6	Providing and fixing Aluminium section 2.5"x1.5" powder coated partly 6mm thick glass and partly both side pre-laminated 12mm thick board including necessary fittings such as rubber gaskets, aluminium bedding etc.complete in all respect all as Directed by engineer-In- charge.	130	Sq. ft.					



	As per Approved sample							
16	Providing and supplying revolving chair with imported nylon full back mesh, pneumatic seat height adjustment, extra padded seat, adjustable arm rest, built in lumbar support, medium back sheet, synchronic movement, imported wheels, heavy duty arm support and base, any position tilt lock mechanism, high quality chrome base. Colour : black Seat size : 21" w x 17" D Seat height : 22" w x 25" D Overall dimensions : 22"W x 18" D x 41"-44" H Material : Fabric	18	No.					
17	Providing and fixing file storages 18mm pre lama partical boards finish having size 4'x4'x1'4"	6	No.					
Total A=								
B) Electrical work								
WIRING AND WIRING ACCESSORIES								
1	Wiring for circuit/ submain wiring along with earth wire with the following sizes of FR PVC insulated copper conductor, single core multistrand wires in surface/ recessed medium class medium class 2 mm thick 25 mm dia PVC conduit / casing patti as required including fish wire, chasling & making good to the damage with wire mesh to original finish							
1.	2 X 2.5 sq. mm + 1 X 2.5 sq. mm earth wire [Make: Polycab/ R R cable/ Finolex/ Universal]	120	Met re					
1.	2 X 6 sq. mm + 1 X 6 sq. mm earth wire [Make: Polycab/ R R cable/ Finolex/ Universal]	70	Met re					
2	Supply & fixing following modular switch/ Socket on the existng modular plate & switch box including connection but excluding modular plate etc. as required							
2.	5/15 amp switch (For Power socket) [Make: Anchor / Havells / Legrand/ schinder]	54	Nos .					
2.	6 pin 5/15 amp socket outlet (For Power socket) [Make: Anchor / Havells / Legrand/ schinder]	54	Nos .					
3	Supply & fixing following size/modules, GI box along with modular base and cover plate for modular switches in recess etc as required.							

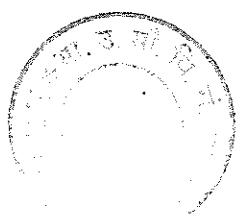

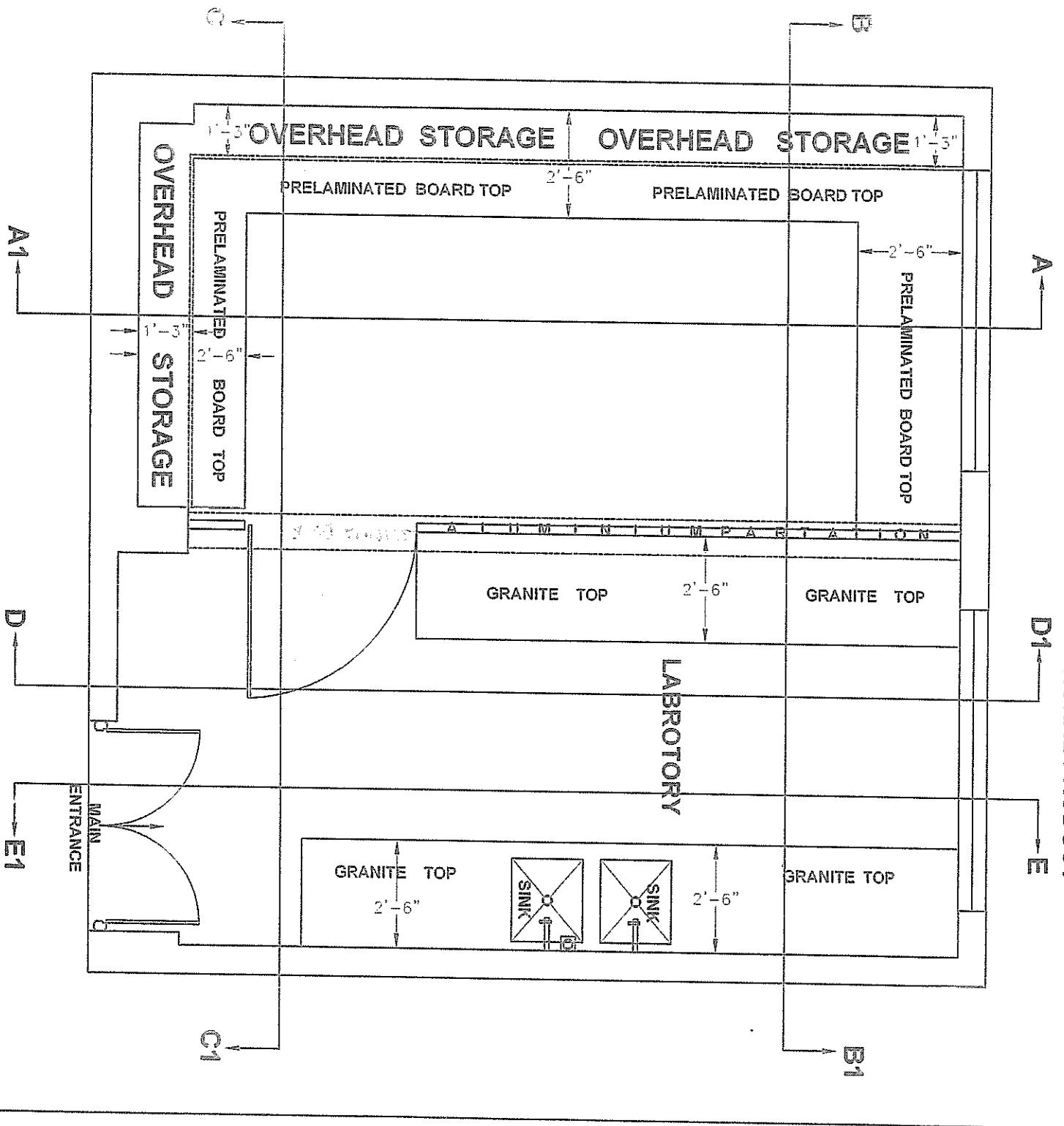

PRODUCED BY AN AUTODESK EDUCATIONAL PRODUCT

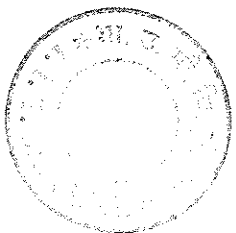

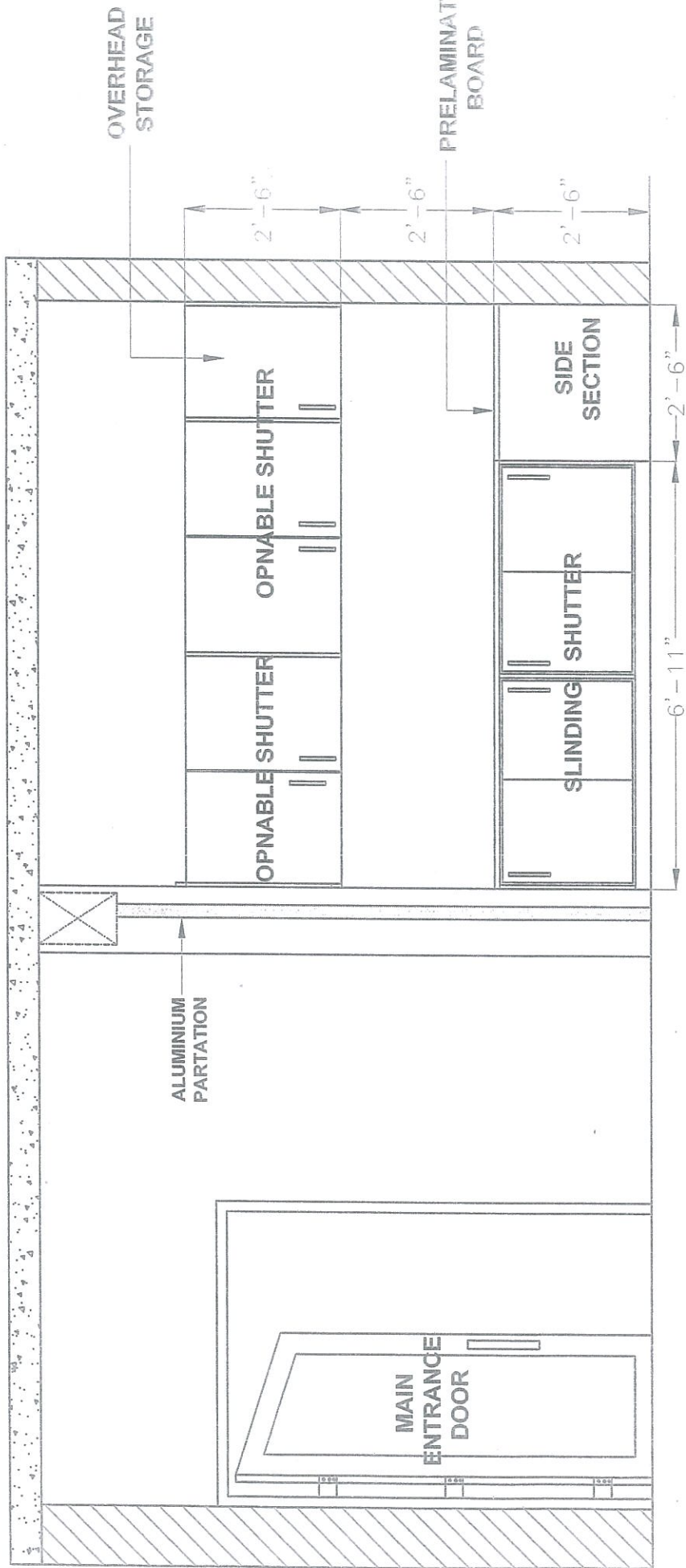

ELEVATION CC 1

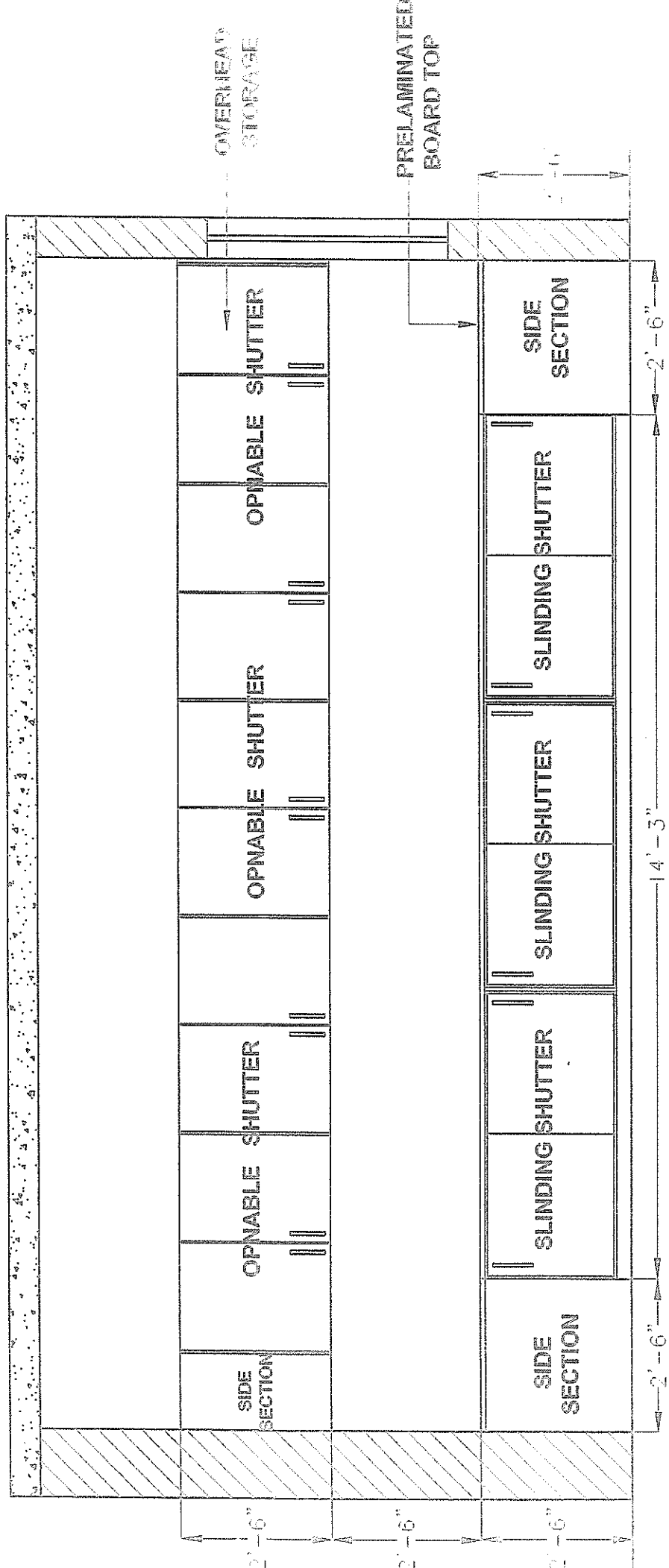
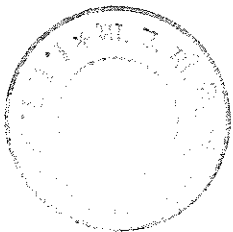

ELEVATION AA1

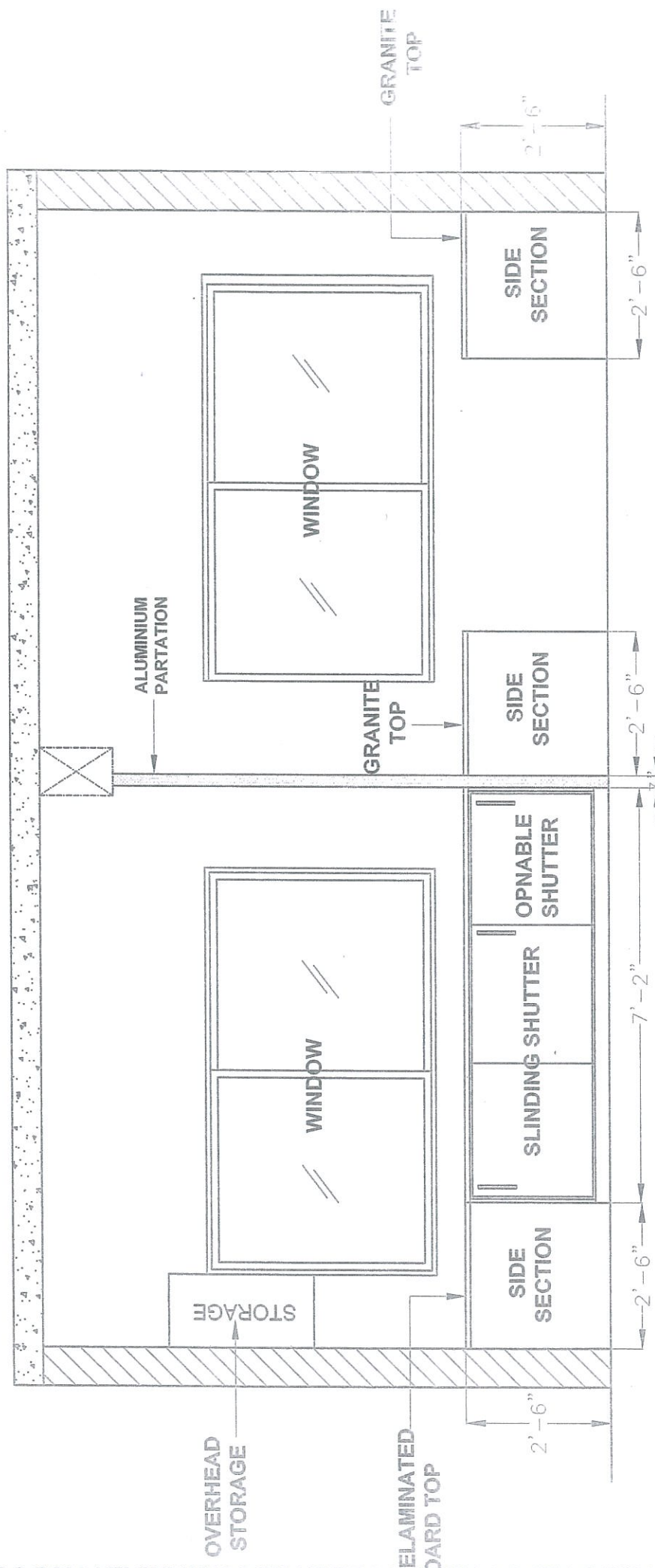

ELEVATION BB1



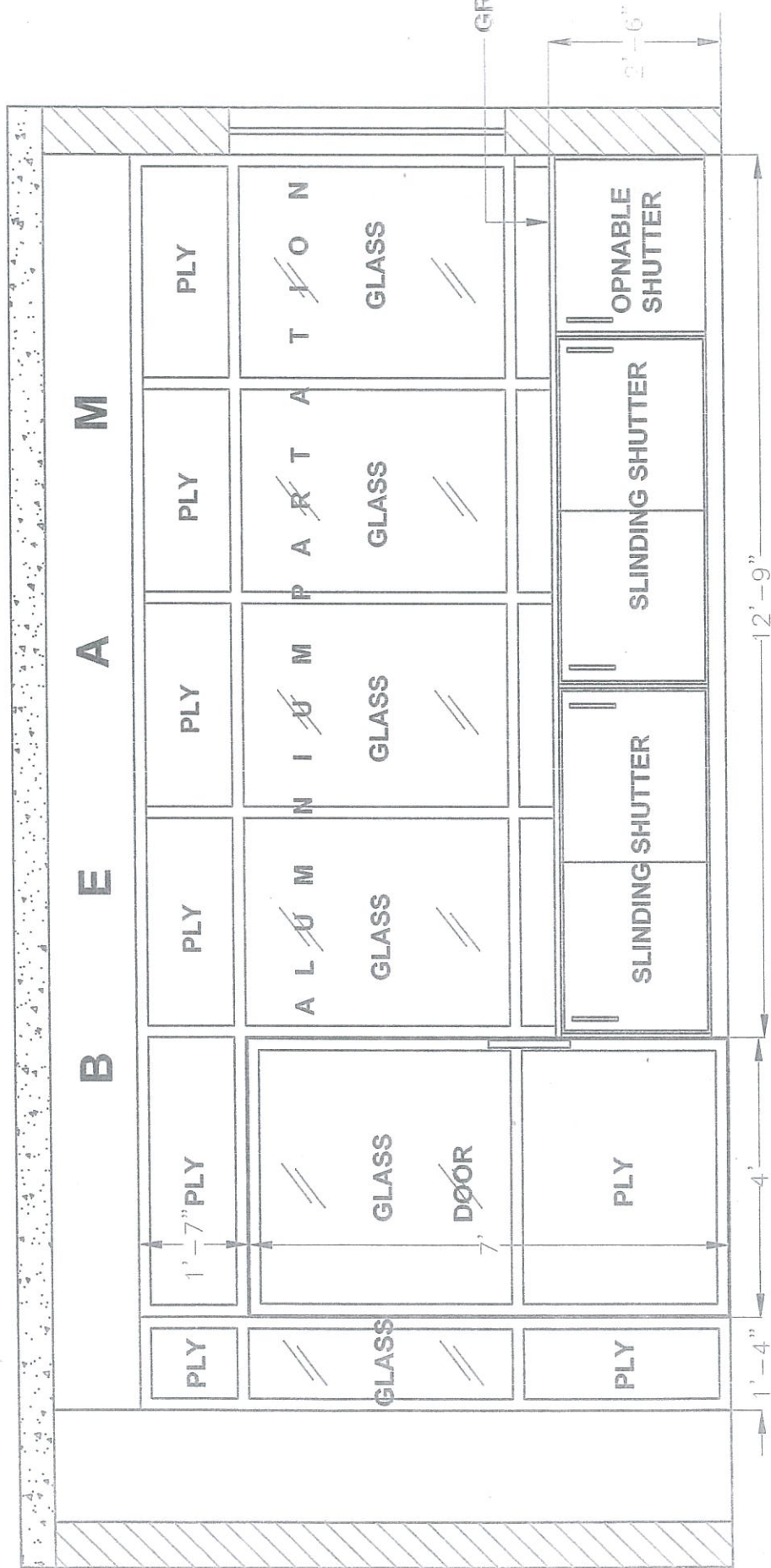

ELEVATION DD 1



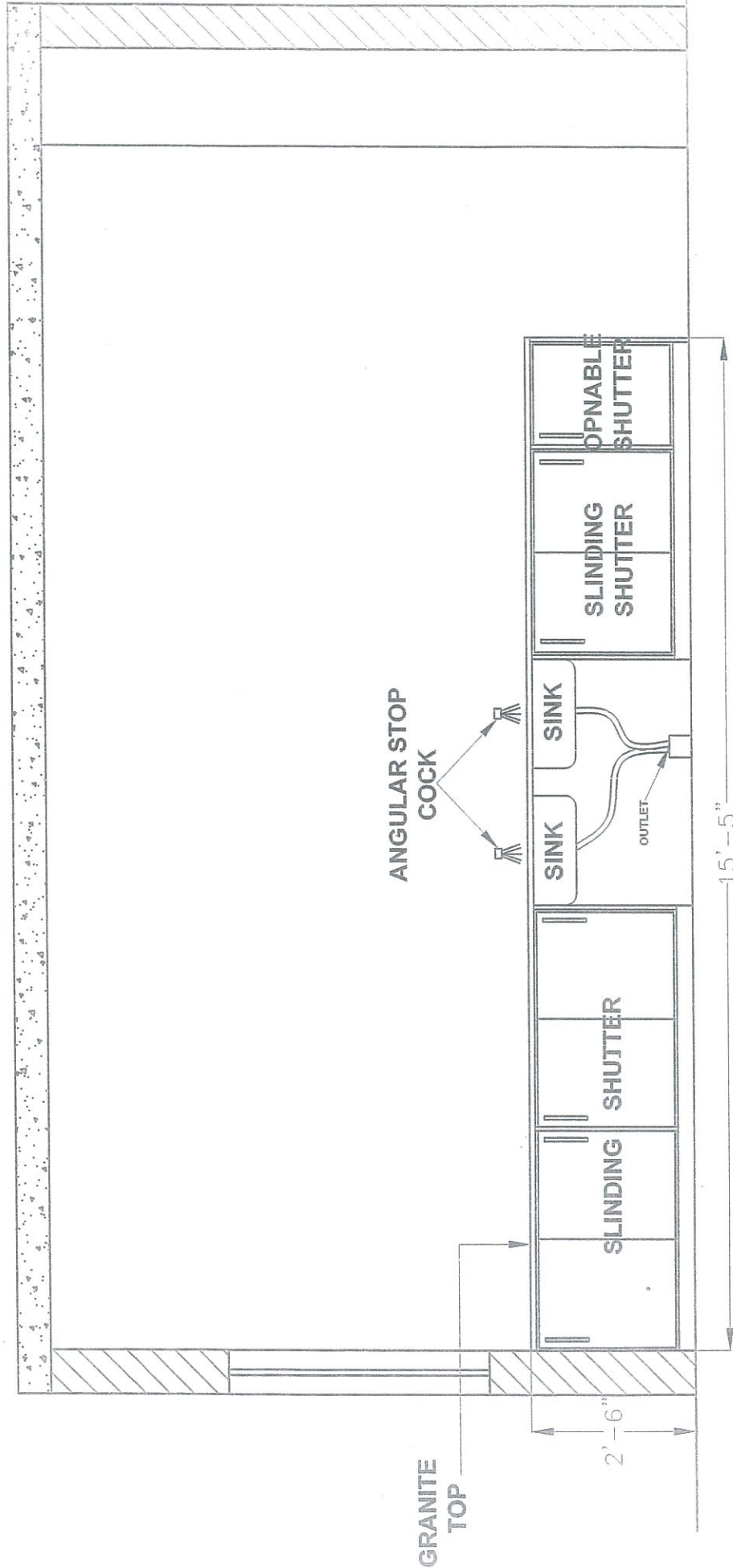

ELEVATION EE1

PRODUCED BY AN AUTODESK EDUCATIONAL PRODUCT

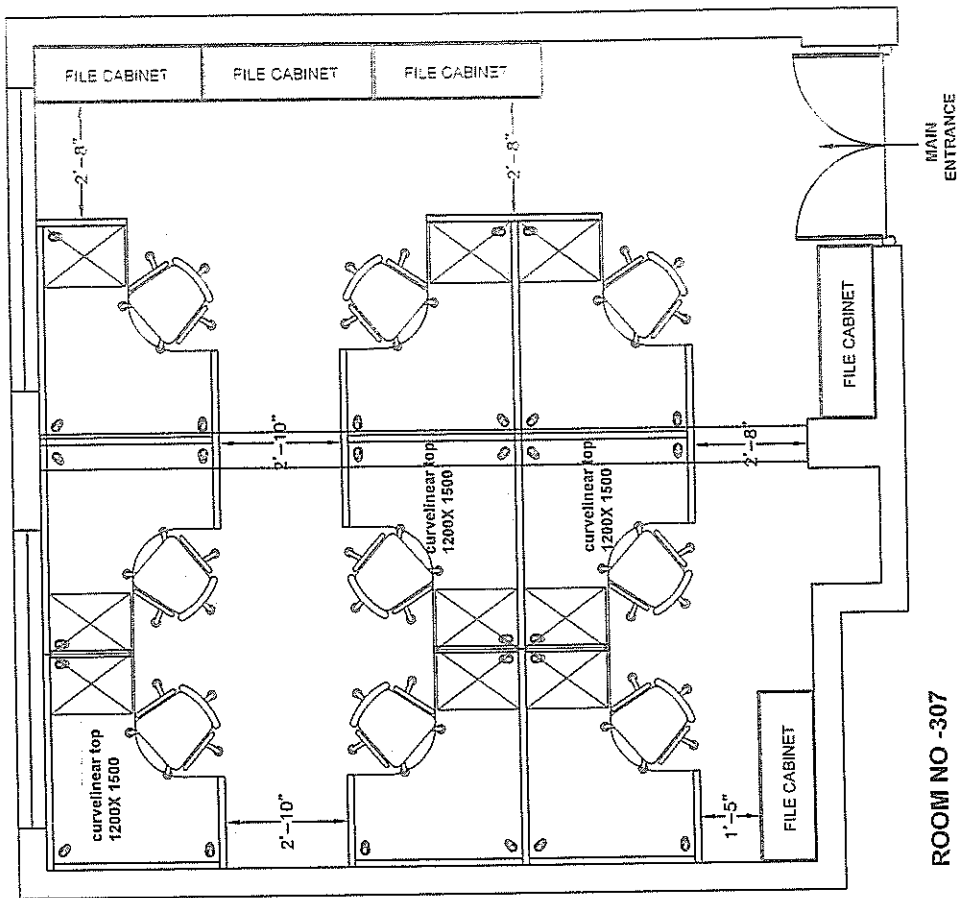

ROOM NO - 307

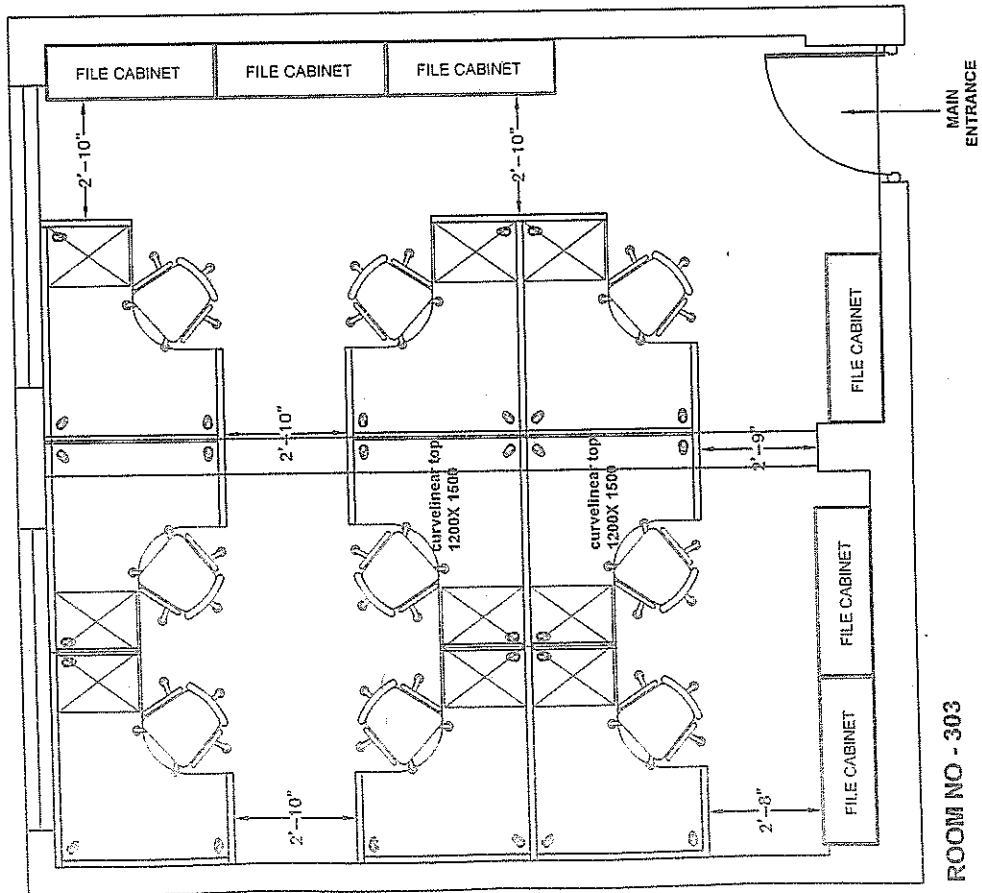

ROOM NO - 303

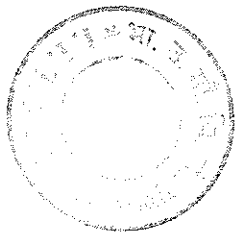

VOLUME-II

COMMERCIAL BID



Sr. No	Description	Qty.	Unit	Basic Rate Rs.	Taxes		Total rate (Basic + taxes) Rs.	Amount
					Service tax %	Vat %		
A) Civil work								
1	Dismantling of existing mosaic wall tiles (skirting) including back coat plaster racking of brick work joints etc to make it clean and ready for new back coat plaster as required for new tiling work and removing of all debris out of IITM premises all as directed by Engineer-in-charge.	3	Sq.m.					
2	Dismantling of old wash basins and shifting to store including fitting fixtures etc. & disposing off the debris material beyond PMC limit all as directed by Engineer In charge.	2	No.					
3	Providing and fixing storage counter 2' 6" depth x 2' 6" height with 18mm thick ply board for top, bottom sides and front sliding/ openable shutter and 12mm thick ply board with both side laminate for back side, necessary vertical support at 3' c/c including edge laminate / lipping, all necessary support fittings fixtures such as runner / guide rail, handles, hinges, key locks etc. complete in all respect all as Directed by engineer-In- charge.	30	R.ft.					
4	Providing and fixing over head storage depth 2'6" x width 1'3" with 18mm thick ply board for top, bottom sides and front openable shutters and back side 12mm thick plyboard with both side laminate , necessary vertical support at 3' c/c including edge laminate / lipping , all necessary support fittings fixtures such as handles, hinges, magnet , key locks etc. complete in all respect all as Directed by engineer-In- charge.	30	R.ft.					
5	Providing and fixing working platform width 2'6"x height 2'6" with below storage in 18mm thick ply on top and 18mm thick granite top and for sides, bottom & front with 18mm thick ply both side laminate , edge laminate/ lipping including necessary support, fittings, fixtures such as handles, hinges, magnet , key locks etc. complete in all respect all as Directed by engineer-In-charge.	30	R.ft.					

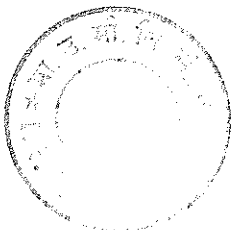

6	Providing and fixing Aluminium section 2.5"x1.5" powder coated partly 6mm thick glass and partly both side pre-laminated 12mm thick board including necessary fittings such as rubber gaskets, aluminium beeding etc.complete in all respect all as Directed by engineer-In-charge.	130	Sq.ft.					
7	Providing and fixing Aluminium section 2.5"x2" powder coated sliding shutter(7'x4') with partly in 6mm thick glass and partly 12mm thick both side pre-laminated board including necessary fittings and fixtures such as handles, locks, sliding runner, rubber gasket, aluminium beeding etc.complete in all respect all as Directed by engineer-In-charge.	30	Sq.ft.					
8	Supplying and fixing ceramic laboratory basin/sink in granite (in rectangle 630x450 with maximum clear depth) including necessary plumbing work with required fitting and plumbing material etc. such as brackets, bib cocks, stop cocks, inlet outlet connections, pillar taps etc. complete in all respect all as directed by engineer-in-charge.	2	No.					
9	Providing & applying cement plaster 20 mm thick in double coat. First coat in c.m. (1:4) & Finishing coat in c.m. (1:2) with sand face finish to concrete & brick surfaces in all positions including all types of finishing such as cornice, molding, pattas, scaffolding & curing etc. complete as directed.	5	Sq.m.					
10	Providing and fixing 10 mm thick and (300 x 300)mm in size acid and/or alkali resistant tiles of approved make and colour using acid and/or alkali resisting mortar bedding, and joints filled with acid and/or alkali resisting cement as per IS : 4457, complete as per the direction of Engineer-in- Charge. In flooring on a bed of 10 mm thick mortar 1:4 (1 acid proof cement : 4 coarse sand) Acid and alkali resistant tile	39	Sq.m.					

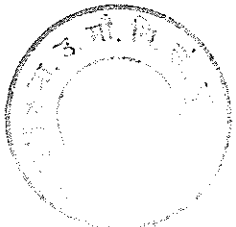

11	Providing and fixing 10 mm thick and (300 x 300)mm in size acid and/or alkali resistant tiles of approved make and colour using acid and/or alkali resisting mortar bedding, and joints filled with acid and/or alkali resisting cement as per IS : 4457, complete as per the direction of Engineer-in- Charge. In dado/skirting on 12 mm thick mortar 1:4 (1 acid proof cement : 4 coarse sand) Acid and alkali resistant tile	3	Sq.m.					
12	LUSTER PAINT two or more coats including preparation of old painted surfaces, primer coat complete all as directed by Engineer-in-charge.	330	Sq.m.					
13	Vinyl Flooring: Providing and laying in pattern 2mm thick vinyl flooring roll form of Mipolam & Triplan series of Gerflor or Armstrong or approved quality, make fixed with approved adhesive as per the manufacturers specifications. The adhesive used for laying the vinyl floor shall be as per the written recommendation made by the manufacturer. The vinyl flooring shall be laid having seamless joints with proper joint treatment using matching shade PVC trims with soft welding as per manufacturers specifications and as approved by the Architects. The copy of the Adhesive recommendation, Original warranty Certificate for minimum of 10 years against de-colourisation, delamination of vinyl floor, PVC trims and soft welding shall be submitted with the Handing Over Report after the completion of installation at site from the Principal manufacturer. This also includes providing, laying and curing of average 5mm thick self leveling compound of Roffee/ Fosroc or approved equivalent make below the Vinyl flooring for achieving the smooth, hard and absolutely leveled surface to avoid undulations in the top vinyl flooring. Procurement and Installation of the vinyl flooring shall be started, only after Architects written approval on shade, make and methodology statement submitted by the Vendor. (Basic price of the vinyl tiles/ roll = Rs 135/- per sft inclusive of duties and taxes) Location: For room no. 307 & 303	75	Sq.m.					

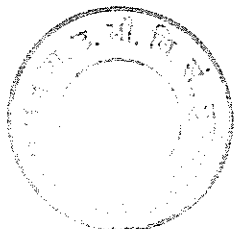

	of FR PVC insulated copper conductor, single core multistrand wires in surface/ recessed medium class medium class 2 mm thick 25 mm dia PVC conduit / casing patti as required including fish wire, chasling & making good to the damage with wire mesh to original finish							
1.1	2 X 2.5 sq. mm + 1 X 2.5 sq. mm earth wire [Make: Polycab/ R R cable/ Finolex/ Universal]	120	Metre					
1.2	2 X 6 sq. mm + 1 X 6 sq. mm earth wire [Make: Polycab/ R R cable/ Finolex/ Universal]	70	Metre					
2	Supply & fixing following modular switch/ Socket on the existing modular plate & switch box including connection but excluding modular plate etc. as required							
2.1	5/15 amp switch (For Power socket) [Make: Anchor / Havells / Legrand/ schinder]	54	Nos.					
2.2	6 pin 5/15 amp socket outlet (For Power socket) [Make: Anchor / Havells / Legrand/ schinder]	54	Nos.					
3	Supply & fixing following size/modules, GI box along with modular base and cover plate for modular switches in recess etc as required.							
3.1	8 Modular box(125mmx125 mm) (For Power socket/ELV Purpose) [Make: Anchor / Havells / Legrand/ schinder]	18	Nos.					
4	Supply & fixing following modular base and cover plate for modular switches in recess etc as required.							
4.1	8 Module (For Power socket/ELV Purpose) [Make: Anchor / Havells / Legrand/ schinder]	18	Nos.					
5	Supply & fixing of 12 way MCB Box enclosed in 1.6mm thick, CRCA sheet steel box. The box shall be concealed / Surface in the wall. The plate cover is properly aligned & flush with the wall surface all materials will be in contractor scope. [Make: Anchor / Havells / Legrand/ schinder]	2	Nos.					
6	MCB							
6.1	32 A 4P MCB [Make: Legrand/ havells/ I&t/havells]	2	Nos.					
6.2	16A SP MCB [Make: Legrand/ havells/ I&t/havells]	18	Nos.					
Total B=								



C) Computer work									
1	CAT 6 Cable Dlink	3	box						
2	TR box Dlink	38	No.						
3	Face plate two way	20	No.						
	CAT 6 I/O	38	No.						
4	CAT 6 patch cord- 1 m Dlink	38	No.						
5	CAT 6 patch cord- 2 m Dlink	38	No.						
6	Patch panle 48 port Dlink	1	No.						
7	Cable manager for 48 port patch panel	1	No.						
8	Cooling fan for 9 U network rack	1	No.						
9	2" casing capping Patti 2 meter length	40	No.						
10	CAT 6 cable laying charges	915	Mete r						
11	Installation of rack & termination	1	job						
			Total C =						
			Grand Total A+B+C =						

